



Taiwan  
Advanced  
Nanotech

Handy  
Quick Start  
Click & Go



CE IVD

Smart LabAssist  
SLA-E13200

Automated  
Nucleic Acid  
Extractor

Prefilled reagents, just add your  
sample and you are ready to go!



## Features

SLA-E13200 is a magnetic bead-based nucleic acid extraction system, fully automated, can process 1 to 32 samples simultaneously within a short period of time (40 to 60 min), to obtain high purity nucleic acid. The instrument easy operation eliminates the risk of human error and cross-contamination, replacing traditional centrifuge method.



### Fully Automated

- SLA-E13200 can simultaneously process 32 samples
- Using TANBead prefilled reagents only need to add samples to run extraction program



### Easy Operation

- Completely automated, highly consistent results
- Installation with USB , easy operation, laptop connection is not necessary



### Stability

- Built-in UV light, reduce chance of cross-contamination
- Two heating plates, accurate temperature control system, allow to run extraction at optimal temperature

## Operation Procedure

- 1 300µlserum + 10µl PK  
> column #1/#7.

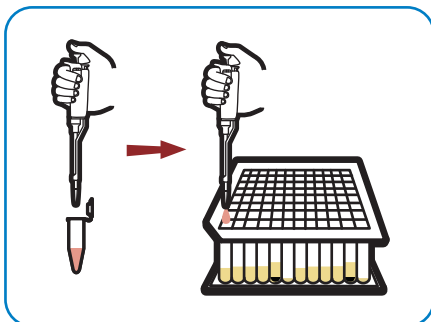

- 2 Push assemble reagent  
tube to the plate rack

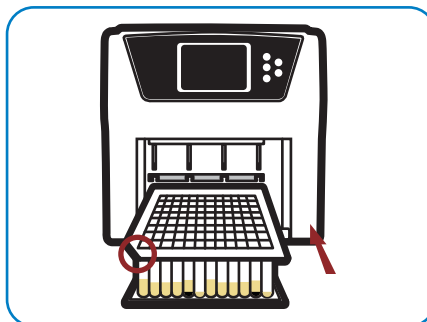

- 3 Push strips to the strip  
rack frame

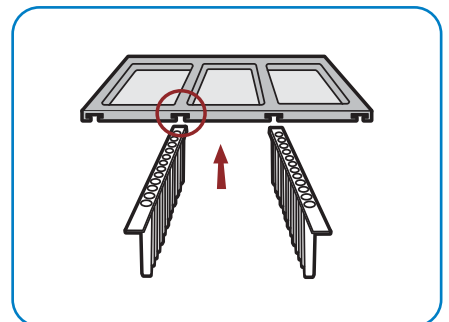

- 4 Execute the extraction  
protocol & Start

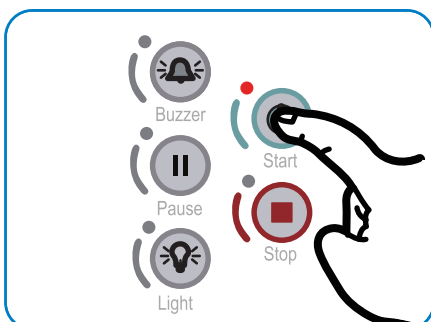

- 5 Program ended when  
buzzer alarm

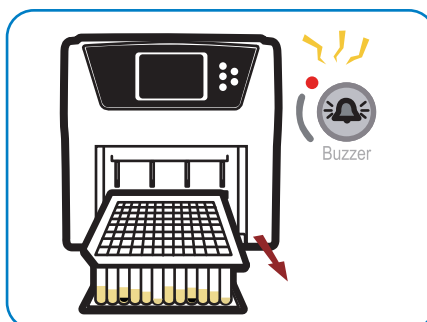

- 6 Get nucleic acid from  
column #6/#12

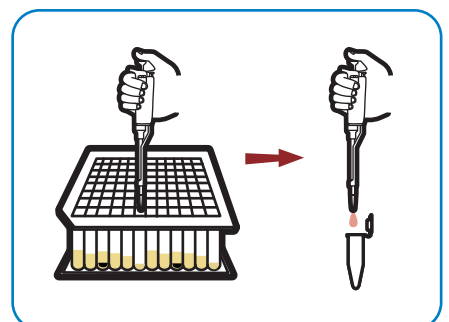

## Performance

HBV RNA Real-time PCR

Linear Performance across a wide concentration range ( $10^2$  IU/ml~ $10^8$  IU/ml)

Successfully detected & identified

TANBead Cat. No. 615A46

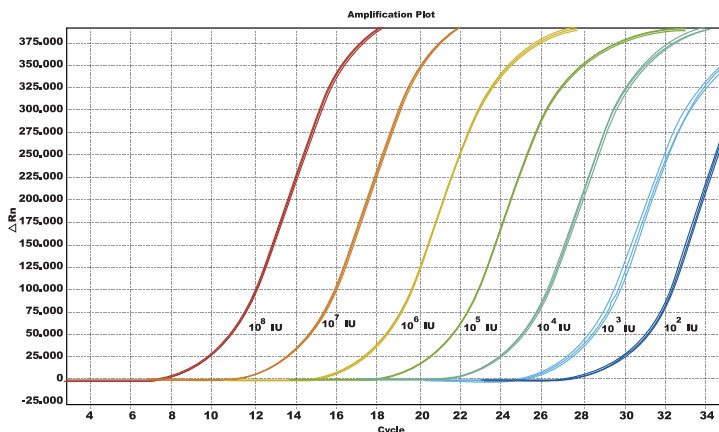

## Specification

Model	SLA-E13200
Run Time	45~60 min
Samples per run	Max 32 samples
Weight (NW)	21kg
Dimensions (WxDxH)	38x35x37cm
Power Supply	3.2A 100-240 V
Processing volume	50 $\mu$ l - 1,000 $\mu$ l
Magnetic Rod	>4300 gauss
Temp control	1 set
Heating Block	Yes (2 pcs)
Heating	RT~70°C
UV Lamp	Yes
Display	5.5" touch screen

## Pre-filled with reagents

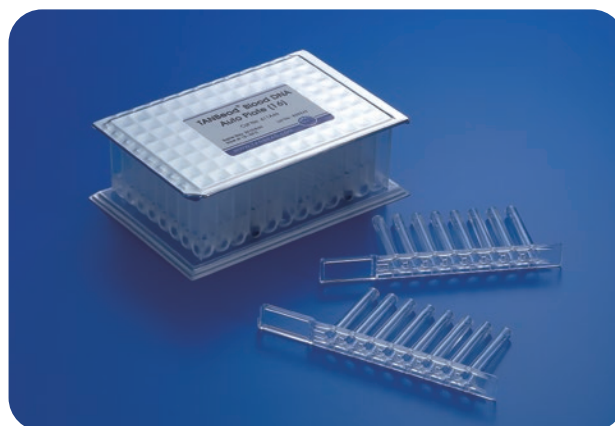

Pre-filled reagent, only needs to add sample in the well.





## Reagent kits

Scan QR code for more reagents



Sample	Target	Test	Kits Format	Ordering No.
<b>Blood</b>	Genomic DNA	96	Auto Plate	301001
<b>Plant</b>	Genomic DNA	96	Auto Plate	301373
<b>Rice</b>	Genomic DNA	960	Auto Plate	301036
<b>FFPE</b>	Total DNA	96	Auto Plate	301251
<b>Tissue</b>	Total DNA	96	Auto Plate	301015
<b>Virus</b>	Viral OptiPure DNA / RNA	96	Auto Plate	301009
<b>Fungi</b>	Genomic DNA	96	Auto Tube	301029
<b>Gram Bacteria</b>	Bacteria Total DNA	96	Auto Plate	301033

## Consumables

Images	Product Name	Format	Description	Ordering No.
	96 deep well plate	Auto Plate	<ul style="list-style-type: none"> <li>Processing volume 50µl-1,600µl</li> <li>Widely use for molecular diagnostics</li> </ul>	083.MWP01.20X
	8 strip A	Auto Plate Auto Tube	<ul style="list-style-type: none"> <li>A unique design to maximum stirring efficiency</li> </ul>	104155
	6 tube B	Auto Tube	<ul style="list-style-type: none"> <li>Special Package for single or small number of tests</li> <li>Minimal consumable waste</li> <li>No reagent loss</li> </ul>	104143
	16-Base B	Auto Tube	<ul style="list-style-type: none"> <li>Incorporate with 6 tube B for small number of tests</li> </ul>	104026

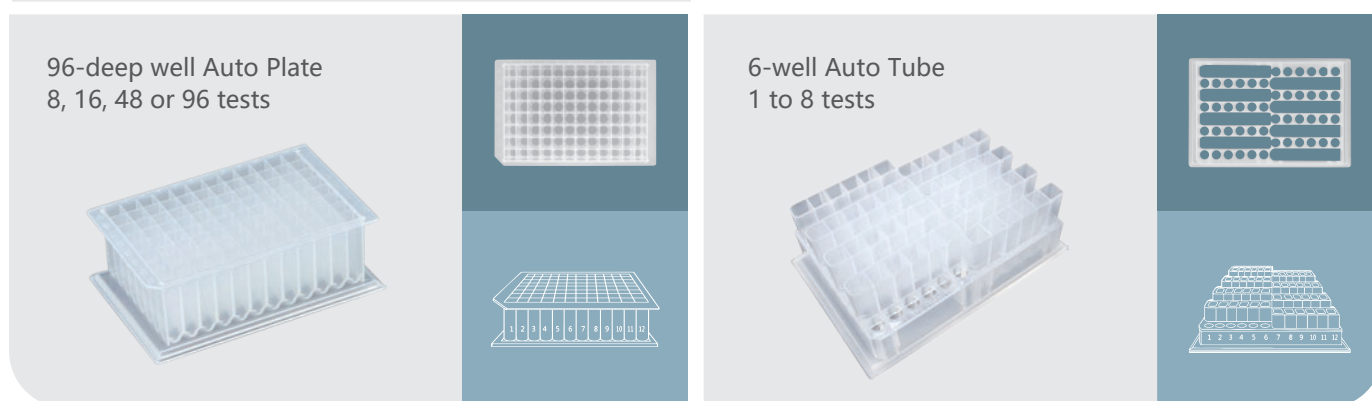
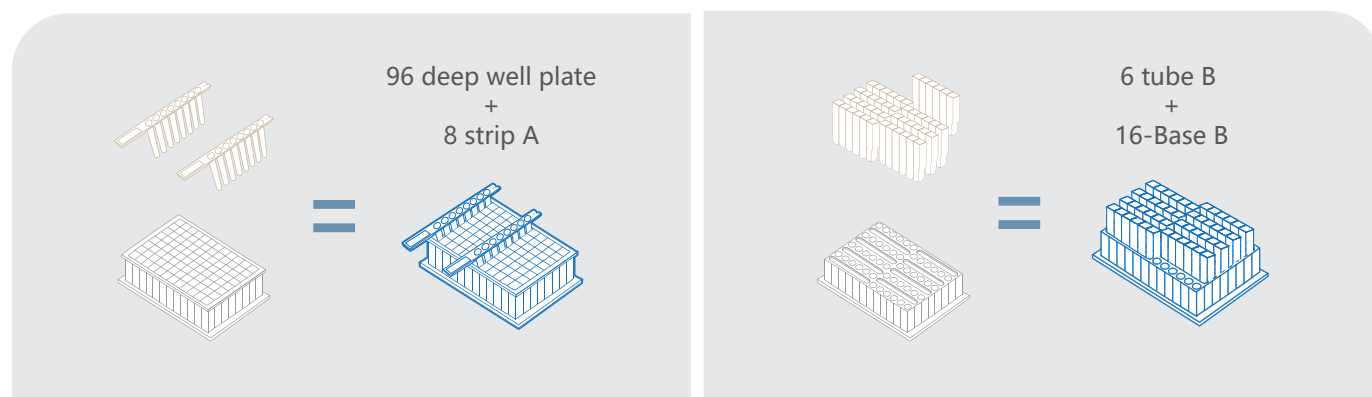

Taiwan Advanced Nanotech

[www.tanbead.com](http://www.tanbead.com)

6F., No. 188, Wenhe Rd., Guishan Dist., Taoyuan City 333, Taiwan

T. +886-3-3167568 F. +886-3-3173369 E. [success@tanbead.com](mailto:success@tanbead.com)

2021-02